

Submersible pump with impeller and grinder for pumping wastewater and sludges with solids, for pumping of industrial waste water and biological sludge chemically corresponding to the constructional material of the pump.



Construction characteristic

- pump body of cast iron GG20
- cast iron impeller
- grinder ZG9Cr18
- Stainless steel shaft 2 Cr13
- double-sided mechanical seal (C/Ceramics, SiC/SiC)
- power cable 10 m

Motor

- Stainless steel shaft
- dry-run motor
- degree of protection IP 68
- insulation class B
- single phase version with built-in condenser
- speed 2800 rpm
- single phase version with float switch
- max. switching time 30/hour
- power cable H07RN-F 3x1 mm

Usage

- max. pumped liquid temperature 40°C
- pump displacement 20 m
- max flow rate 200 l/min

Aplikace

- pumping water from wells and reservoirs
- pumping waste water
- type of liquid: sludge and waste water with admixture of solid particles such as wood waste and animal waste (skin, bone parts)

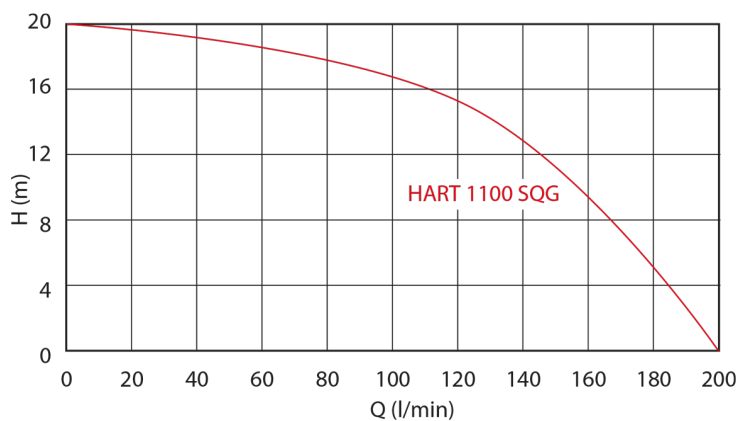

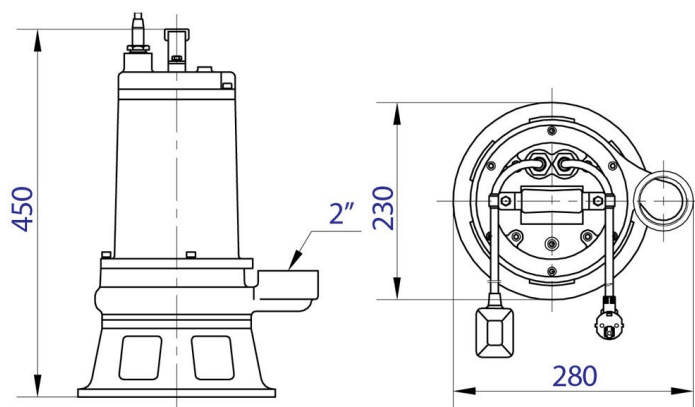

Type:	HART 1100 SQG
Power input:	1100 W
Q max:	12 000 l/h
Head high:	20 m
Voltage:	230 V
Weight:	33 kg
DNM dimensions:	2" - 2 1/4"
Connection:	2" - 2 1/4"
Max. temperature:	40 °C

