

Submersible pump with impeller and cutting device for pumping wastewater and slurries containing fiber. The pump is equipped with 10 m cable, float switch and built-in thermal motor protection.



### Construction characteristic

- pump body of cast iron GG20
- steel impeller ZG 35
- cutting wheel and grinder of ZG40Cr
- Stainless steel shaft 2 Cr13
- double mechanical seal (C/Ceramics, SiC/SiC)

### Motor

- Stainless steel shaft
- dry-run motor
- degree of protection IP 68
- insulation class B
- single phase version with built-in condenser
- speed 2800 rpm
- single phase version with float switch
- max. switching time 30/hour
- power cable H07RN-F 3x1 mm

### Usage

- type of liquid: sludge and wastewater with solid particles and fiber
- max. pumped liquid temperature 40°C
- pump head height 16 m

### Aplikace

- use in industry, in the home
- pumping of waste water and sediments with textile fibers
- liquid chemically compatible with pump material

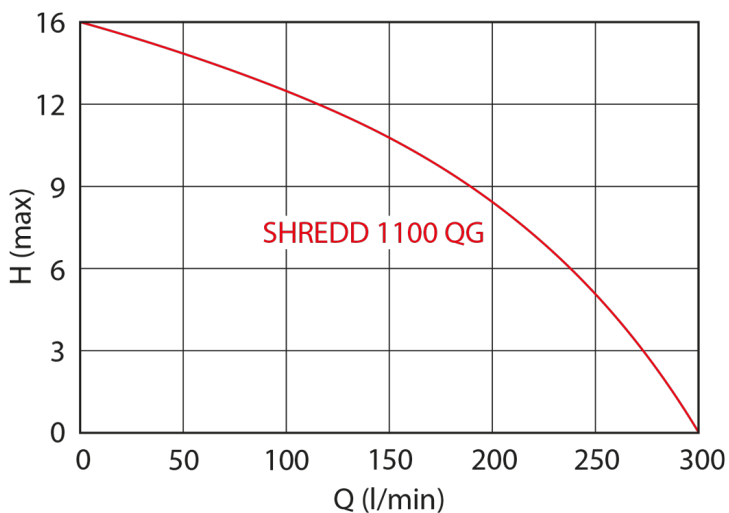

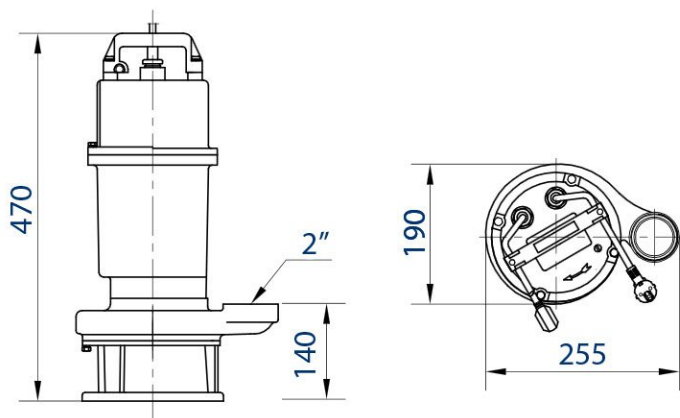

<b>Type:</b>	SHREDD 1100 QG
<b>Power input:</b>	1100 W
<b>Q max:</b>	18 000 l/h
<b>Head hight:</b>	16 m
<b>Voltage:</b>	230 V
<b>Weight:</b>	33 kg
<b>DNM dimensions:</b>	2" - 2 1/4"
<b>Connection:</b>	2" - 2 1/4"
<b>Max. temperature:</b>	40 °C

